

Fire Water Reservoir Section - Directional Boring Detail



- Notes:
1. EXB-08 Groundwater Sample Collected at 82.25' btoc, Which Corresponds to a Depth of 72 Feet bgs.
  2. Groundwater Results Reported in ug/L.

Legend

- Existing Monitoring Well
- New Well/Exploratory Boring Location

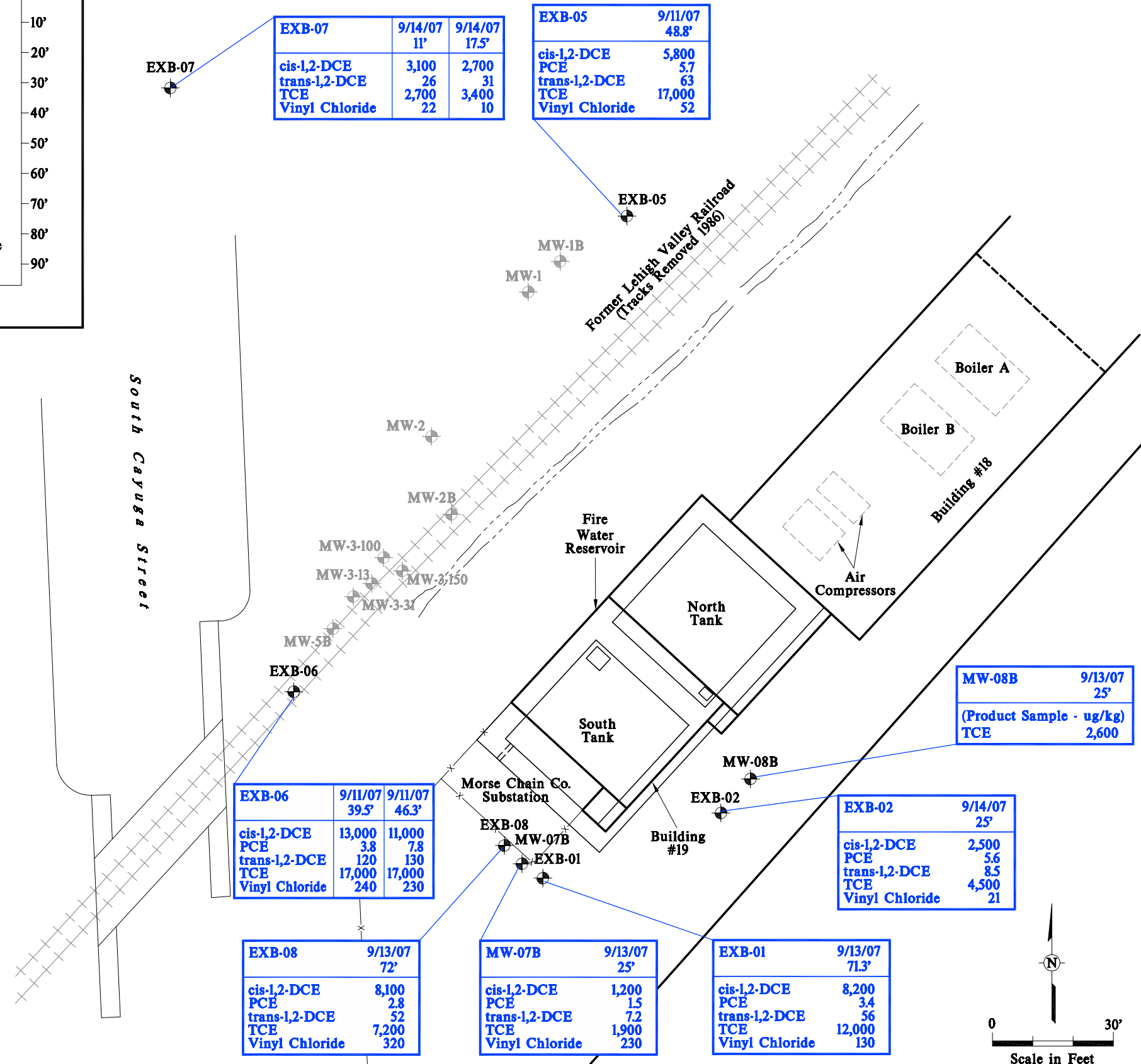

EXB-07	9/14/07	9/14/07
cis-1,2-DCE	3,100	2,700
trans-1,2-DCE	26	31
TCE	2,700	3,400
Vinyl Chloride	22	10

EXB-05	9/11/07
cis-1,2-DCE	48.8'
PCE	5,800
trans-1,2-DCE	5.7
TCE	63
Vinyl Chloride	17,000
	52

EXB-06	9/11/07	9/11/07
cis-1,2-DCE	39.5'	46.3'
PCE	13,000	11,000
trans-1,2-DCE	3.8	7.8
TCE	120	130
Vinyl Chloride	17,000	17,000
	240	230

EXB-08	9/13/07
cis-1,2-DCE	72'
PCE	8,100
trans-1,2-DCE	2.8
TCE	52
Vinyl Chloride	7,200
	320

MW-07B	9/13/07
cis-1,2-DCE	25'
PCE	1,200
trans-1,2-DCE	1.5
TCE	7.2
Vinyl Chloride	1,900
	230

EXB-01	9/13/07
cis-1,2-DCE	71.3'
PCE	8,200
trans-1,2-DCE	3.4
TCE	56
Vinyl Chloride	12,000
	130

EXB-02	9/14/07
cis-1,2-DCE	25'
PCE	2,500
trans-1,2-DCE	5.6
TCE	8.5
Vinyl Chloride	4,500
	21

MW-08B	9/13/07
(Product Sample - ug/kg)	25'
TCE	2,600

Figure 8  
Fire Water Reservoir Groundwater Sampling Results  
Emerson Power Transmission  
Ithaca, New York

11911 FREEDOM DRIVE SUITE 900  
RESTON, VIRGINIA 20190  
(703) 709-6500

